

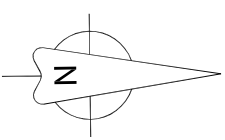

SITE LAYOUT (1:200)

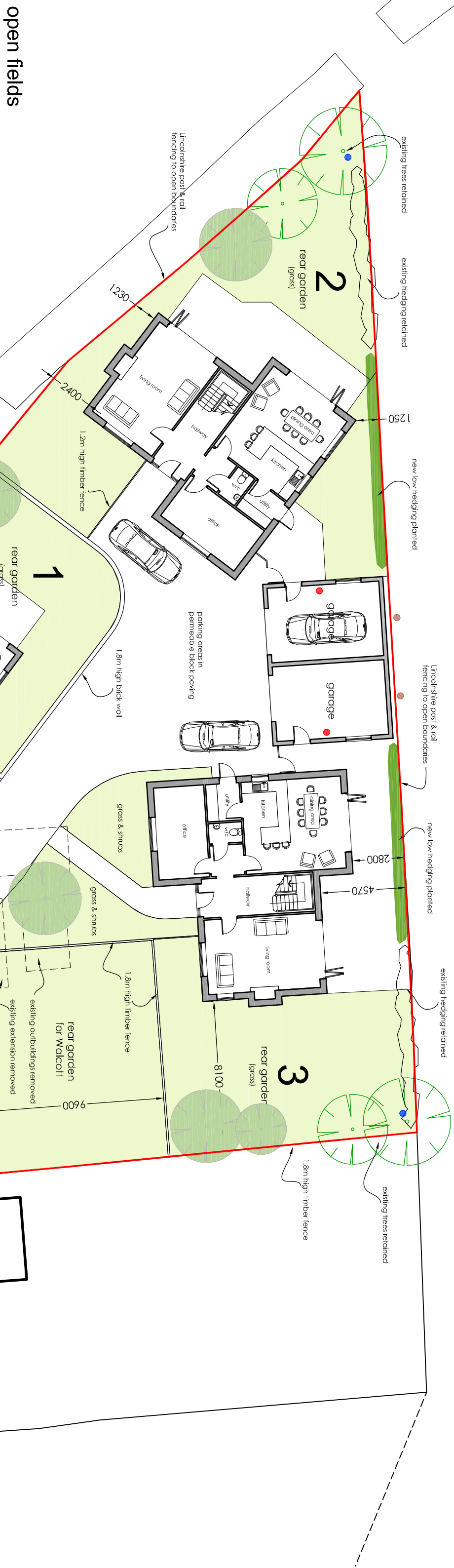

open fields



open fields



SITE LOCATION (1:1000)

© Crown Copyright. All rights reserved. Licence number 100022432



New hedging to be mixed native hedging. This will comprise 50% Hawthorn and then a mix of Blackthorn, Field Maple, Dogrose & Hazel. These would be 30-60cm high with a density of 5 per metre in double staggered rows. Planted with tree shelters, canes & spirals

New tree planting to be medium species, including Golden Alder, Rowen and Wild Service Tree (Chequer). Trees to be 12-14cm girth containerised root stock.

- Electric car charging points
- Bat boxes
- Bird boxes

- C. 04/03/21: Electric car charging points, bat & bird boxes shown
- B. 09/02/21: Access road width increased to 4.2m until it bends
- A. 27/01/21: Landscaping information & scale bar added
- P1. 19/11/20: Initial Issue

• **NEIL • REYNOLDS** •
Sailers Barn, Middle Street, Potterhanworth, Lincoln, LN4 2DR
tel: 01522 793006 e-mail: neil@nkrchitects.co.uk

client
MR J. MACKAY

project
3 No. New Dwellings
Land behind Walcott
Ralphs Lane, Wyburton

drawing title
SITE LAYOUTS

date
November 2020

scale
as shown @ A1

drawing number
ST-428 / 01

revision
C