

Generally

- WINDOWS ARE TO BE SEALED DOUBLE GLAZED UNITS & FITTED WITH TRICKLE VENTS TO GIVE 8000mm² VENT AREA AT EACH UNIT. OPENING VENT AREA OF WINDOWS TO BE MIN 1/20 OF ROOM FLOOR AREA. WINDOWS MAX U-VALUE = 1.6
- ALL GLAZED AREAS ARE TO COMPLY WITH BS 6206 & APPROVED DOCUMENT K — I.E. ANY GLAZING TO WINDOWS WITHIN 200 OF FLOOR LEVEL & TO DOORS & SIDELIGHTS WITHIN 1500 OF FLOOR LEVEL TO BE EITHER TOUGHENED OR LAMINATED GLASS.
- USE INSULATING CAVITY CLOSERS AT OPENINGS TO GIVE A U-VALUE = 1.2 — ALL FRAMES ARE TO LAP THE VERTICAL D.P.C. BY MIN 38.
- CEILING INSULATED CAVITY WALL LINTOLS TO BE USED THROUGHOUT. ALL LINTOLS IN THE EXISTING BUNGALOW WHERE THE NEW ATTIC ROOF IS TO BE SUPPORTED ARE TO BE REPLACED. — LINTOLS LOCATED IN EXISTING 275 WIDE CAVITY WALLS ARE TO BE TYPE CX70/100 (EXTRA HEAVY DUTY) — LINTOL LOCATED IN 285 WIDE CAVITY WALL FORMING NEW LOUNGE EXTENSION TO BE TYPE CG70/100. ENSURE A MIN 150 END BEARING & ALL LINTOLS TO HAVE WEEP HOLES & STOP ENDS.
- PROVIDE NEW SMOKE DETECTORS IN HALL & ON FIRST FLOOR LANDING — TO BE MAINT OPERATED WITH BATTERY BACK UP & INTERCONNECTED.
- TO NEW EN-SUITE, FIX FAN TO GIVE 15 LITRES/SEC VENTILATION RATE — PROVIDE FAN COMMISSIONING CERTIFICATE TO THE BUILDING CONTROL OFFICER
- ALL ELECTRICAL WORK REQUIRED TO MEET THE DEMANDS OF PART P REGARDING ELECTRICAL SAFETY MUST BE DESIGNED, INSTALLED, INSPECTED TESTED & CERTIFIED BY A PERSON COMPETENT TO DO SO.
- FIX 50 DIA WASTE TO BATH & 40 DIA WASTE TO SHOWER & WASHBASIN. FIT 75 DEEP SEAL TRAPS THROUGHOUT.
- ENSURE NEW BEDROOM & NEW LOUNGE WINDOWS HAVE AN OPENING SASH OF CLEAR WIDTH 450 & WITH A MIN AREA OF 0.33m² — ESCAPE WINDOWS
- FIX LOW ENERGY LIGHTING THROUGHOUT.
- HEATING & HOT WATER DETAILS TO BE PROVIDED TO THE BUILDING CONTROL OFFICER UPON DESIGN COMPLETION. EXISTING OIL FIRED BOILER LOCATED IN GARAGE UNAFFECTED BY WORKS. ALL NEW RADIATORS TO BE FITTED WITH T.T.V.'s — THE HEATING ENGINEER TO CERTIFY & COMMISSION THE SYSTEM.
- WHOLESOME WATER & HEATED WHOLESOME WATER TO BE PROVIDED TO BATH SHOWER & WASHBASIN.
- WHERE HOT & COLD WATER TAPS ARE PROVIDED ON SANITARY APPLIANCES THE HOT WATER TAP SHOULD BE ON THE LEFT.
- FIT ANTI SCALD DEVICE TO BATH TO LIMIT THE HOT WATER TEMPERATURE TO 48°C.

STAIRCASE

- BUILD IN NEW STAIRCASE WITH QUARTER SPACED LANDING & SINGLE NEWEL.
- TOTAL FLOOR TO FLOOR RISE = 2600
- GOINGS = 225
- 15 HP RISERS @ 200
- BALUSTRADES TO HAVE GAPS LESS THAN 100 WIDE & BE A MIN. 900 HIGH INCLUDING HANDRAIL.
- MIN VERTICAL HEAD HEIGHT FROM THE PITCH LINE = 2000

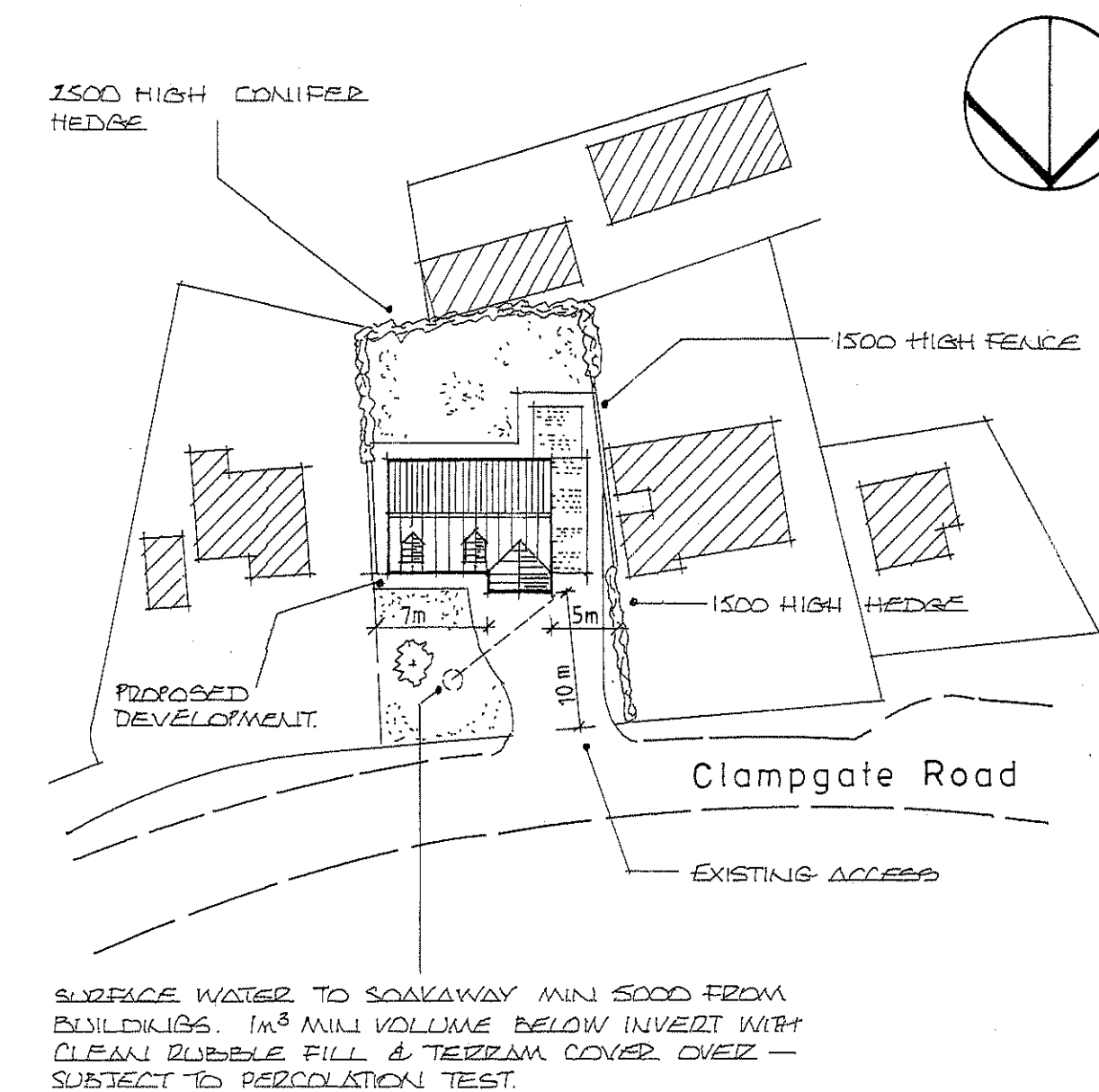
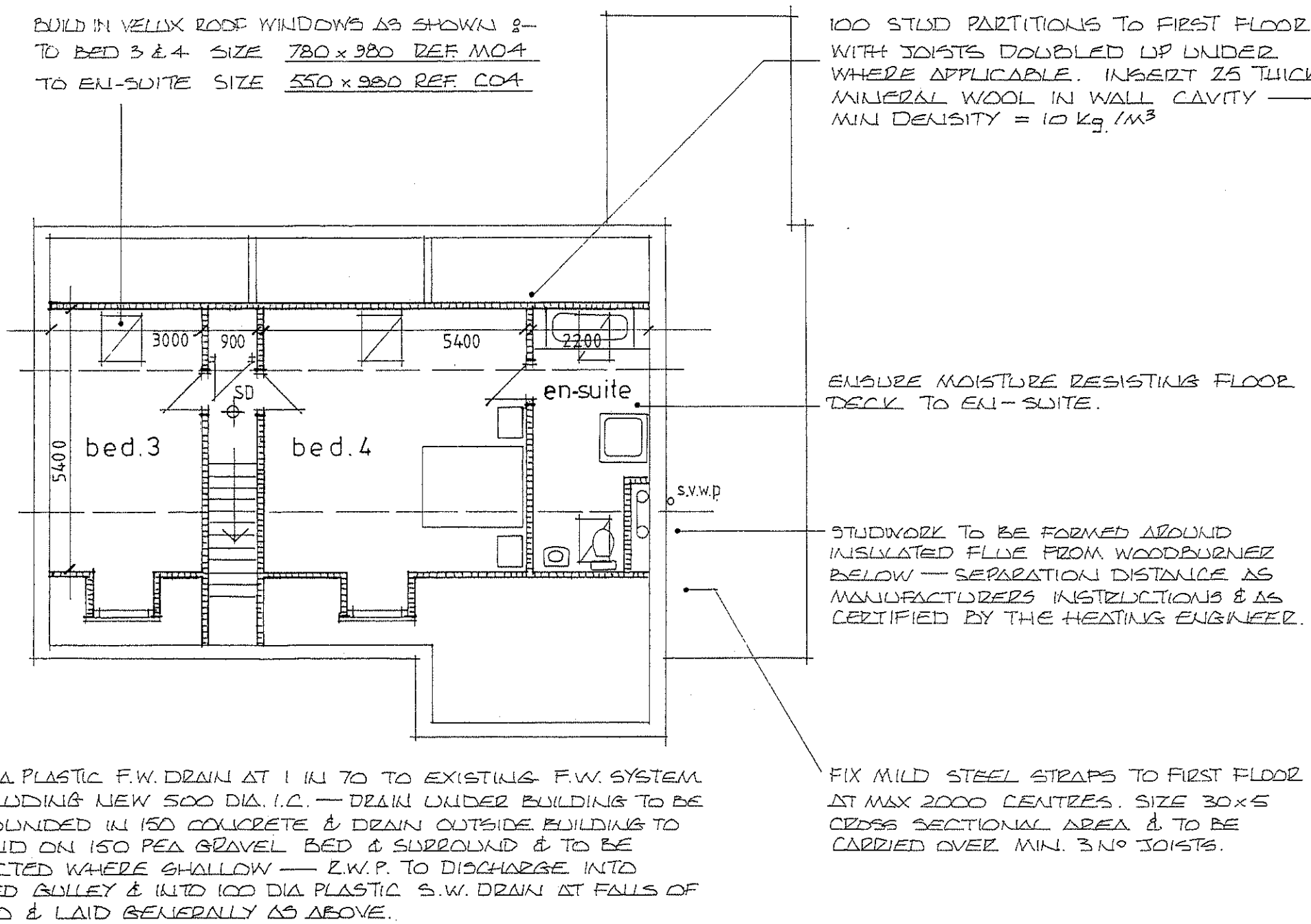
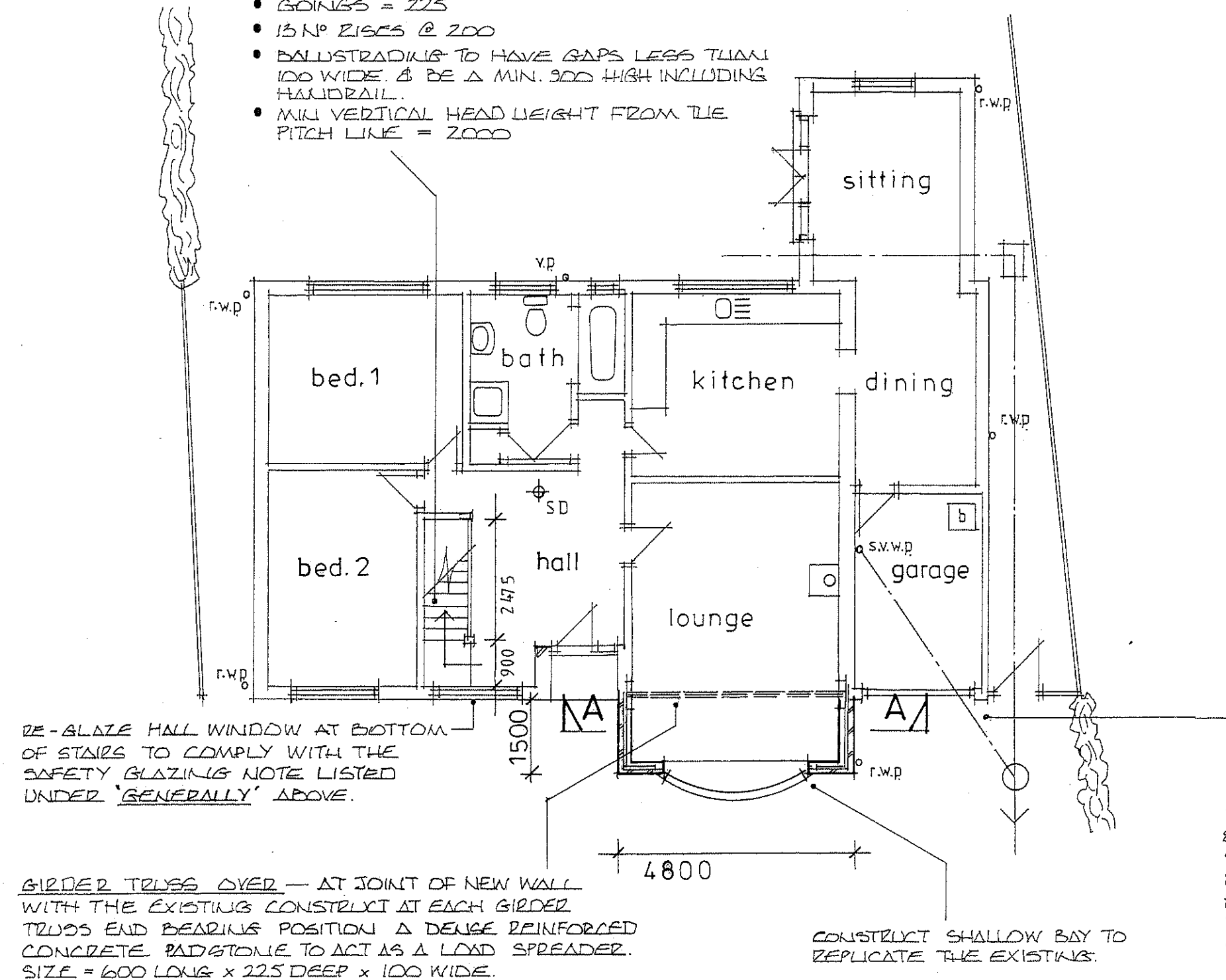

PROPOSED EXTENSION & NEW DORMER ROOF at 'AVALON' CLAMPGATE ROAD FISHTOFT BOSTON PE21 0RY for MR. N. SMITH

AMENDMENTS (SEE NOTES ON PLAN)

- (A) RADSTONES TO GIBBER TRUSS.
- (B) SAFETY GLAZING TO HALL WINDOW.
- (C) DEEPFLOW GUTTERS THROUGHOUT.
- (D) RENDERED FINISH TO FRONT & SIDE ELEVATION WALLS

SCALE 1 / 100, 1 / 500

DRWG. NO.

NS / 2