

TO BE READ IN CONJUNCTION WITH PLANNING, BUILDING REGULATION APPROVALS AND STRUCTURAL ENGINEERS DETAILS AND SPECIFICATION AS NECESSARY  
BASED ON ORIGINAL PLANNING SCHEME DRAWINGS AND DETAILS SUPPLIED BY BY AKM ARCHITECTURE

Copyright L.P.C Architectural Design.  
Do Not Scale This Drawing

Notes:  
- All dimensions to be checked & confirmed on site prior to commencement of works  
- All structural elements to be checked & installed strictly in accordance with structural engineers & Manufactures details & specifications.  
- All foul & surface water drainage systems to be checked & confirmed on site prior to commencement of works.

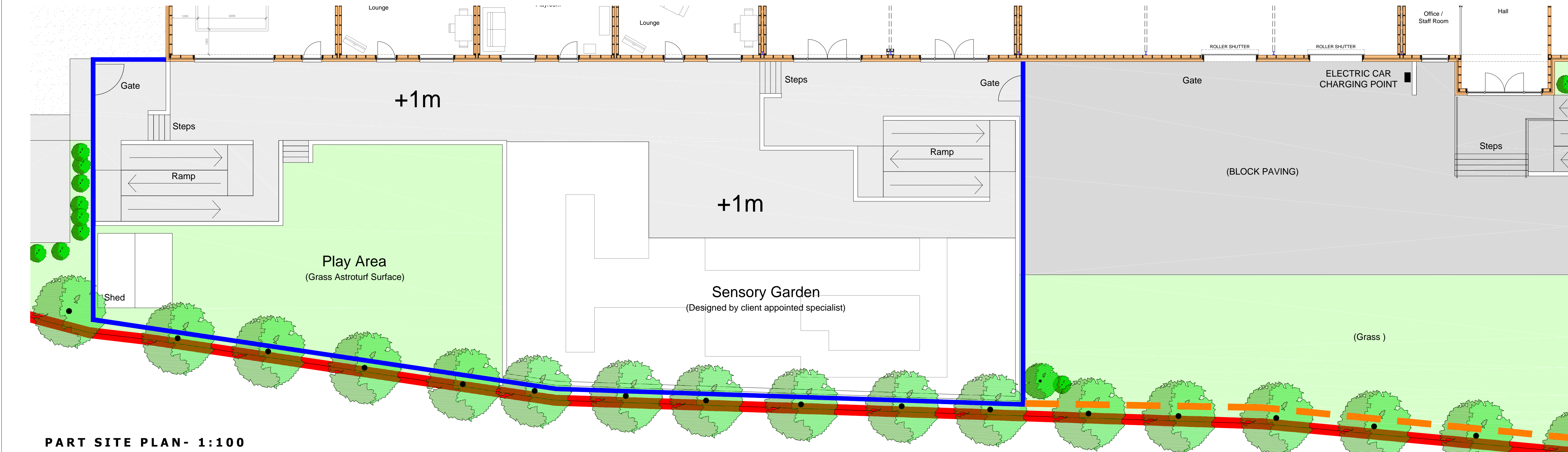
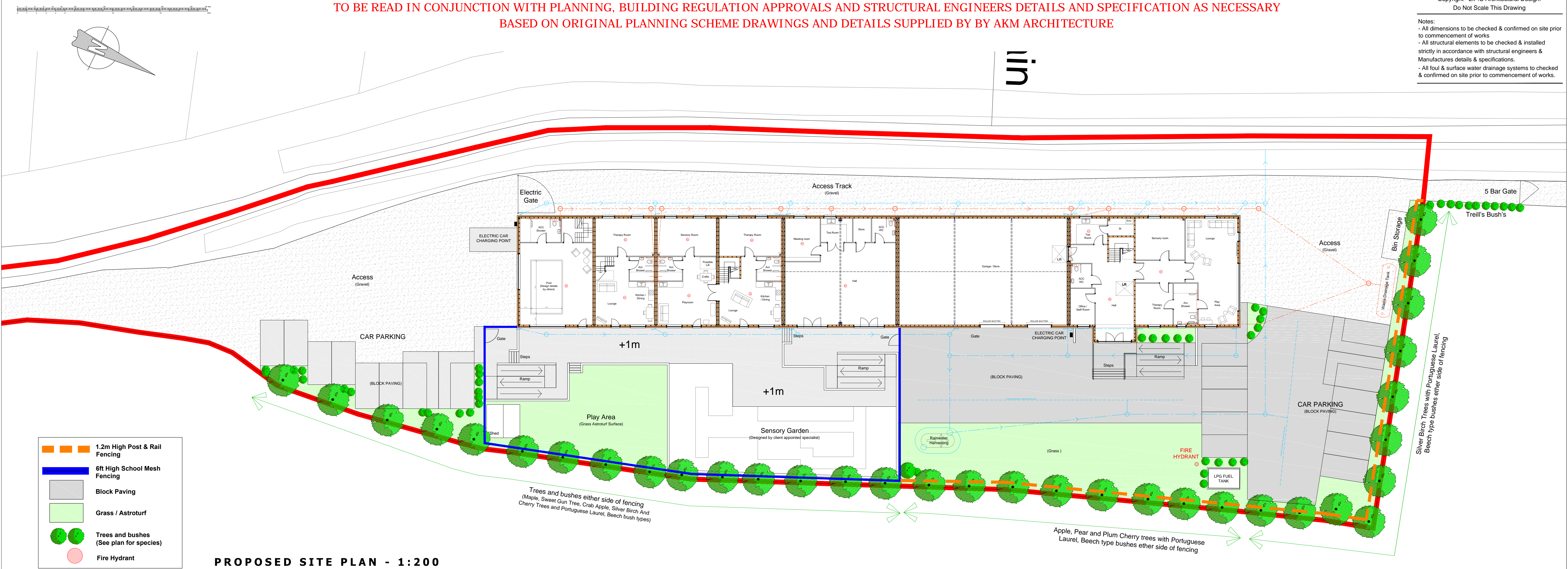

D	LANDSCAPING SCHEME REVERTED TO ORIGINAL AS REQUESTED BY LA PLANNING OFFICER	15-03-2021
C	INDICATIVE DRAINAGE SHOWN & ALTERATIONS TO PLAY AREA	25-02-2021
B	LANDSCAPING DETAILS UPDATED IN LINE WITH CLIENT COMMENTS	17-02-2021
A	LANDSCAPING DETAILS UPDATED	15-02-2021
REV	Note	Date



ARCHITECTURAL  
DESIGN

07930 915730  
lee@lpcdesign.co.uk www.lpcdesign.co.uk

Project/Site  
**SUPPORT CENTRE**

Land at off A52, Butterworth, Boston  
Client  
Mr Codling

Dwg Title  
**PROPOSED SITE PLANS**

Date	JANUARY 2021	Scale	1:200 @ A1
Dwg No	LPC-268-03	Revision	D

Drawing Status  
**BUILDING REGULATIONS**