

REVISION: DESCRIPTION: MADE BY: DATE:

KEY:

- Features to be removed/demolished
- Ceiling height
- Window sill height & head height
- Door head height
- Rainwater pipe
- Soil vent pipe
- Inspection chamber
- Gully
- Direction of joists over
- Section tag
- Radiator

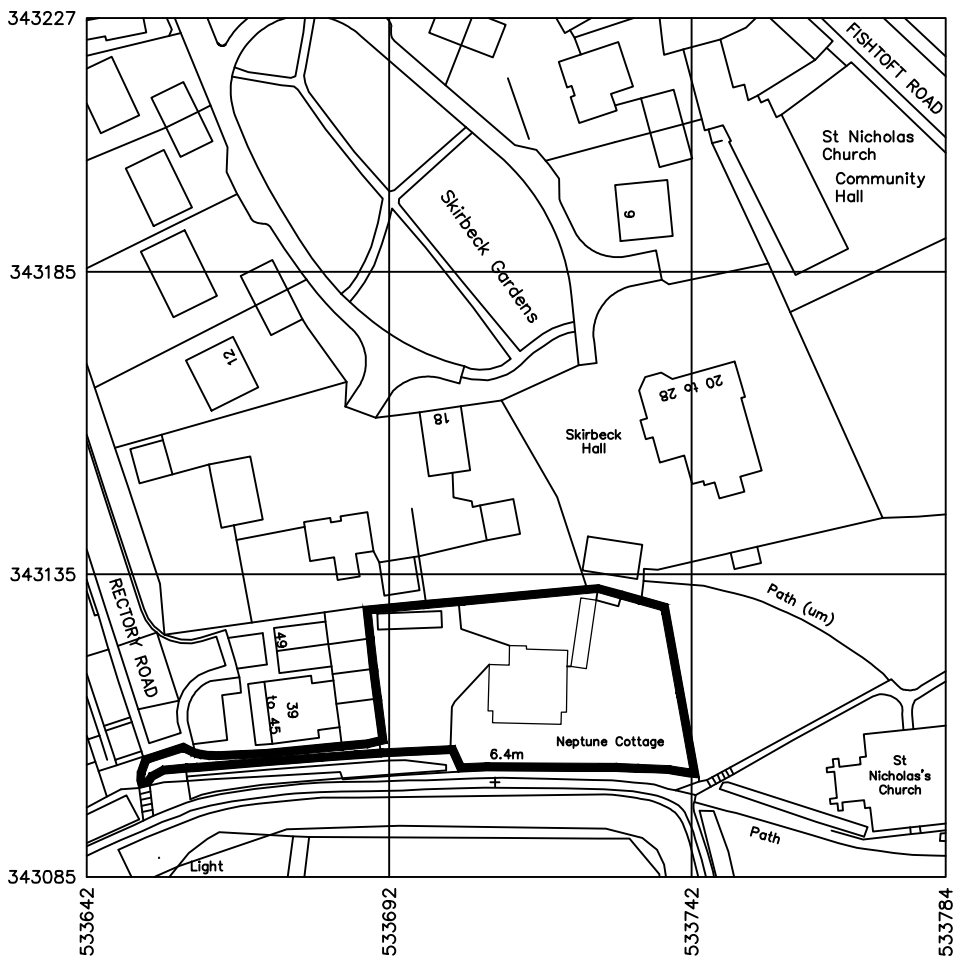

Crown copyright 2020. Supplied by copla ltd trading as UKPlanningMaps.com a licensed Ordnance Survey partner (100054135).

SITE LOCATION PLAN

SCALE 1:1250  
0 10 20 40 60 m  
1:1250

CLIENT: Mr & Mrs Heslop

PROJECT: Proposed extensions & alterations to form annexe, kitchen, dining & living at  
Neptune Cottage, Sea Bank, Boston, Lincolnshire PE21 0AD

TITLE: Ground Floor Plan (As Surveyed) and Location Plan

SCALE: As Shown (A1) REVISION LETTER:

DRAWN: AJR DRAWING NO: B/3472-1001

CHECKED: ORIGINAL SIZE: A1

DATE: OCTOBER 2020

Architectural Consultants

**BOSTON** 12-14 Main Ridge West, Boston PE21 6GQ t: (01205) 357 272 e: boston@neildowdman-architecture.co.uk  
**STAMFORD** 14 Barn Hill, Stamford PE9 2AE t: (01780) 758 522 e: stamford@neildowdman-architecture.co.uk  
**ALFORD** 4-5 Church Street, Alford LN13 9EF t: (01507) 463 863 e: alford@neildowdman-architecture.co.uk  
**HORNCASTLE** 29 St Lawrence Street, Horncastle LN9 5DN t: (01507) 522 899 e: horncastle@neildowdman-architecture.co.uk  
**LOUTH** 62 Northgate, Louth LN11 0LY t: (01507) 601 155 e: louth@neildowdman-architecture.co.uk  
**SKEGNESS** (Satellite Office) t: (01754) 880 080 e: skegness@neildowdman-architecture.co.uk  
\*By appointment only

www.neildowdman-architecture.co.uk

**DOWLMAN**  
Neil Dowdman Architecture

Planning | Design | Project Management

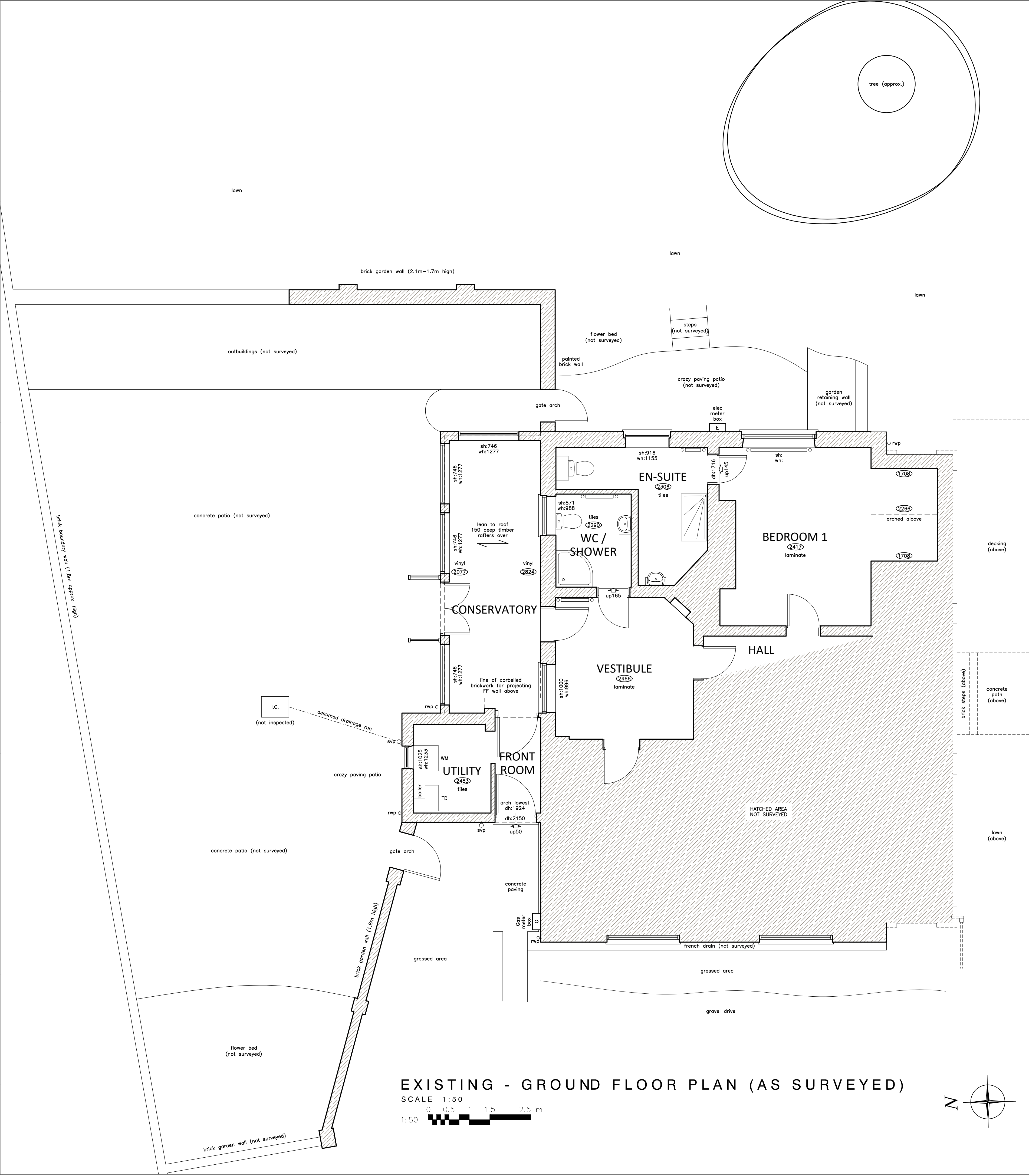

EXISTING - GROUND FLOOR PLAN (AS SURVEYED)

SCALE 1:50  
0 0.5 1 1.5 2.5 m  
1:50

