

External Rainwater Pipe Connection Detail

(Scale 1:10)

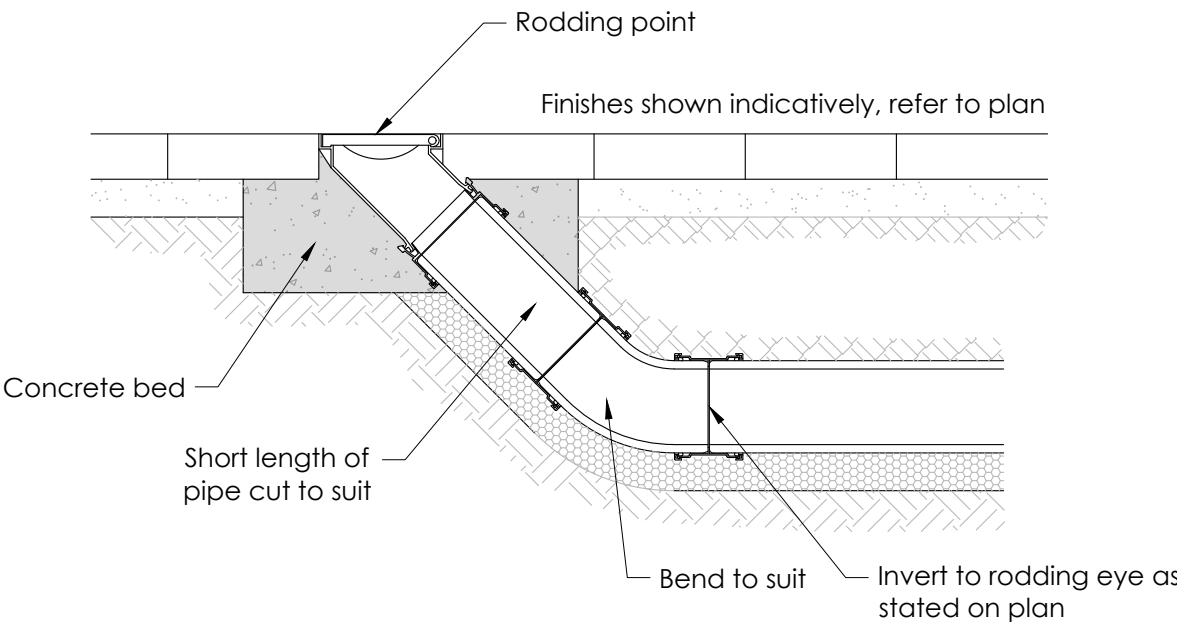

Rodding Eye Detail

(Scale 1:10)

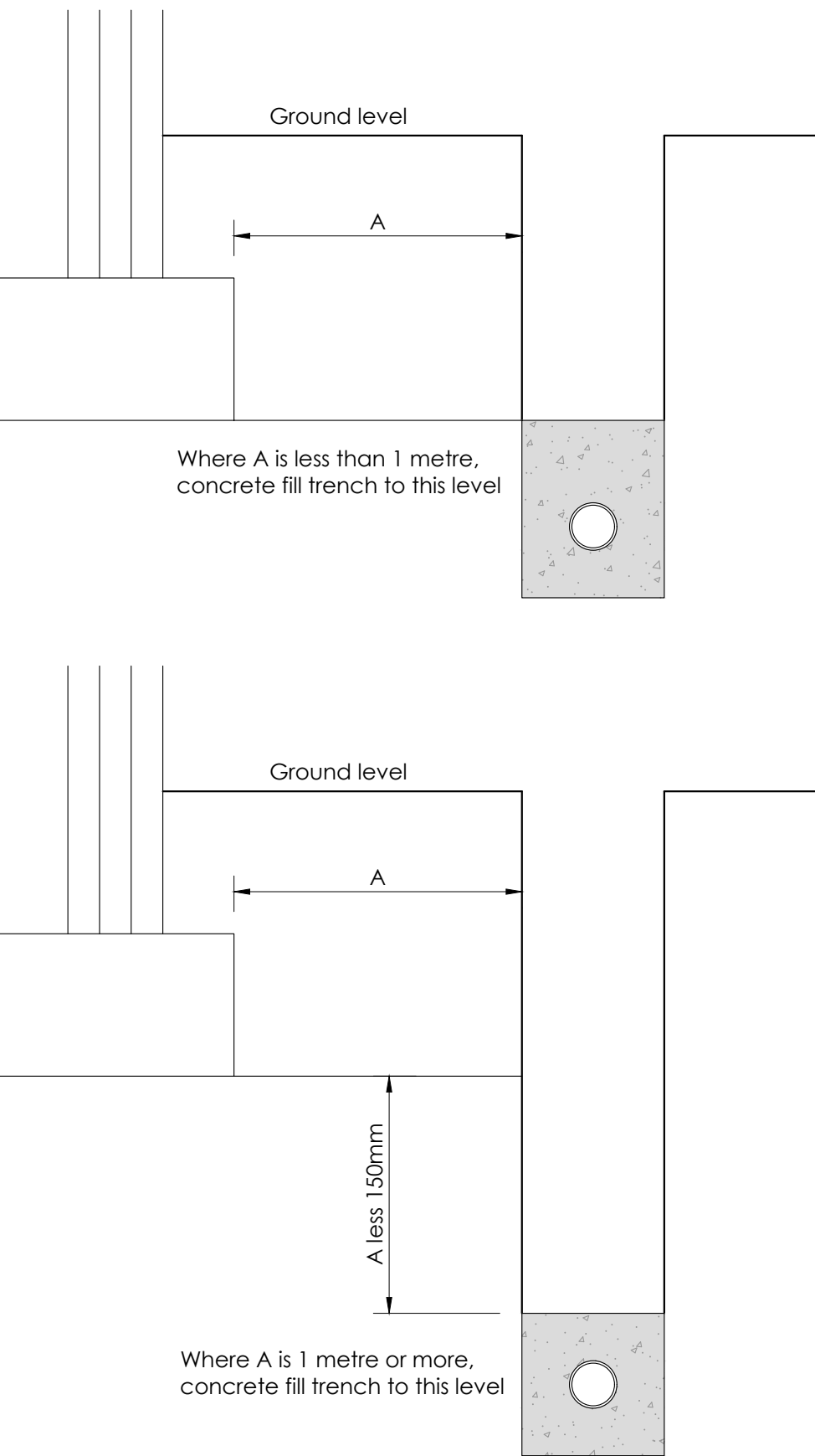

Pipe Runs Near Foundations

(Scale 1:20)

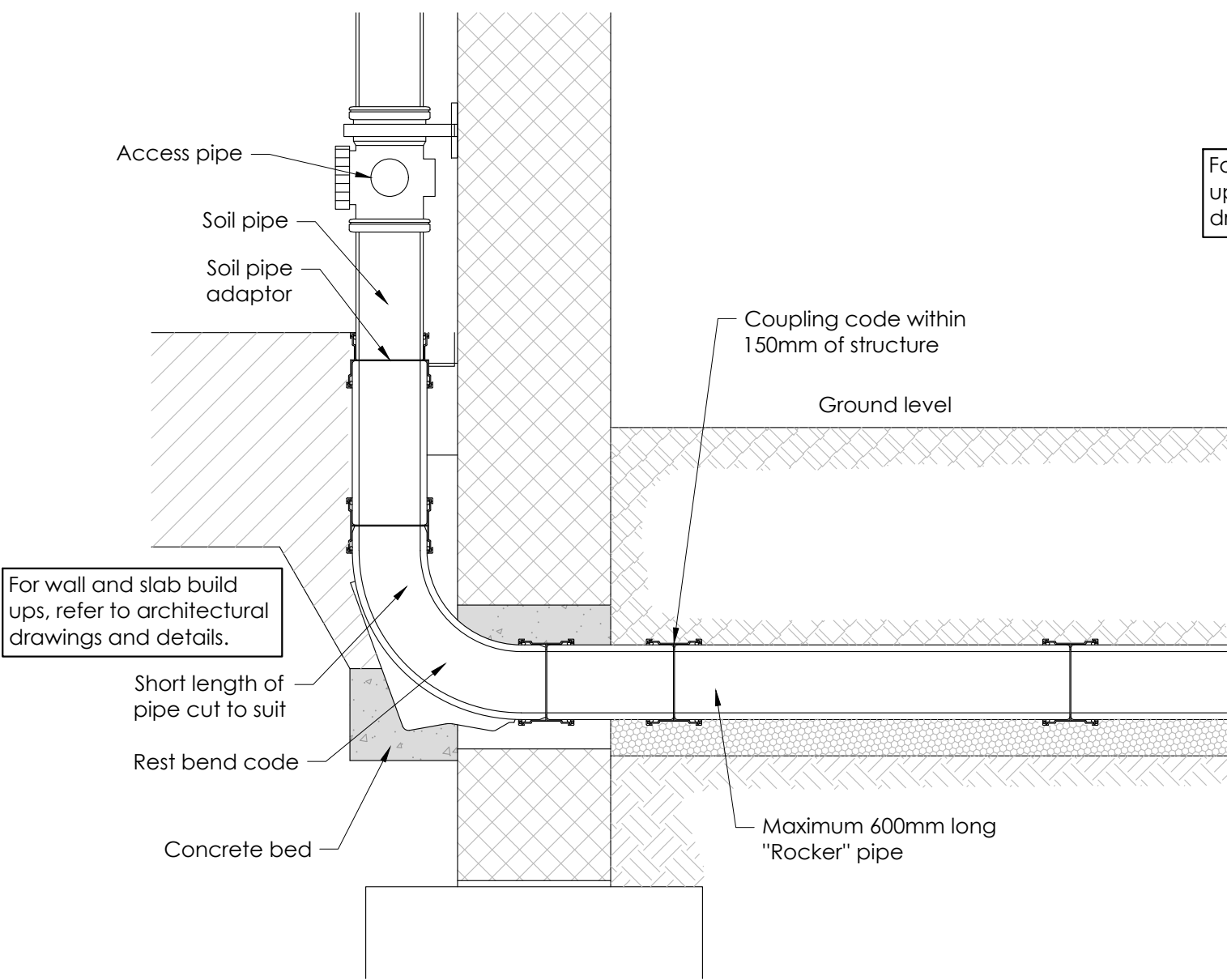

Soil & Vent Pipe/Stub Stack W.P. Connection Detail

(Scale 1:10)

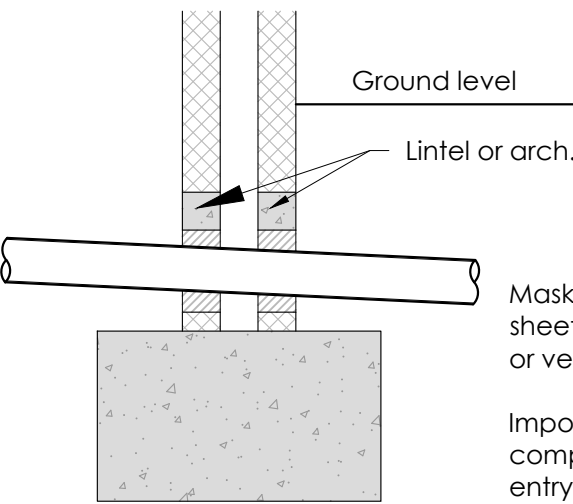

B) Arch or lintel opening to give 50mm space all around the pipe

Pipes Penetrating Walls

(Scale 1:20)

Note:

Where it is necessary to backfill the trench with concrete in order to protect nearby foundations movement joints formed with compressible board should be provided at each socket or sleeve joint face

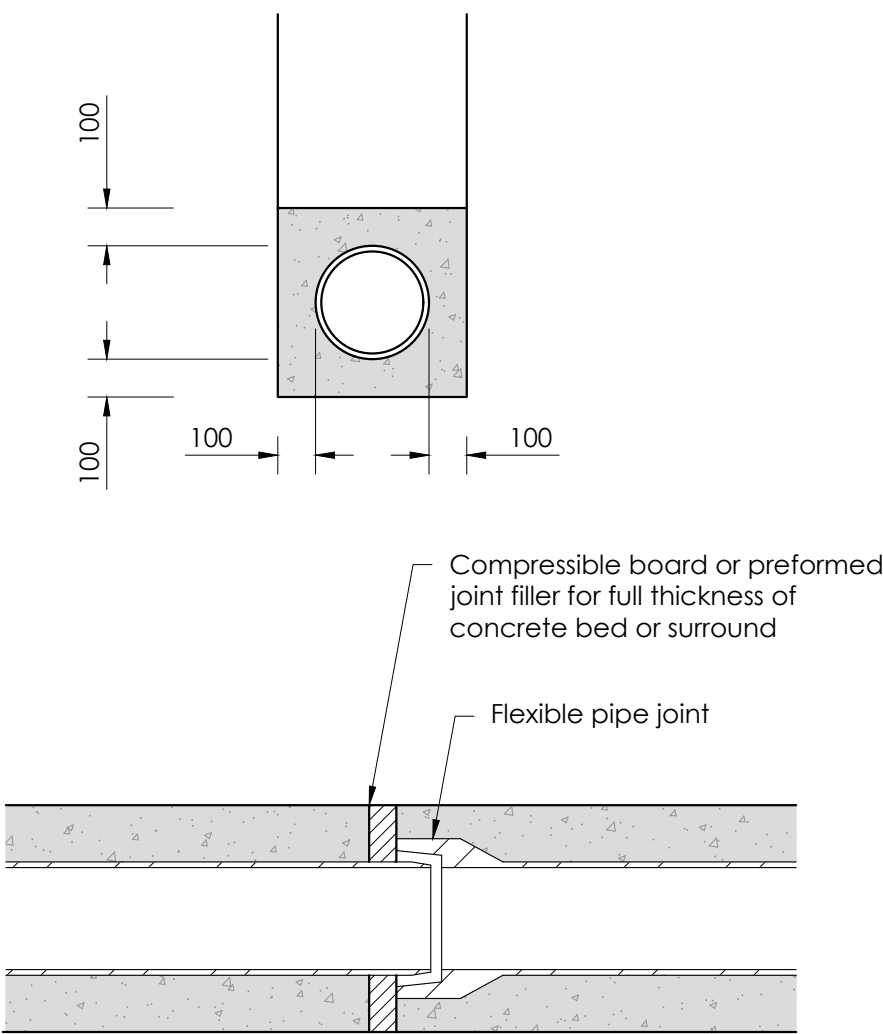

Joints for concrete encased pipes

(Scale 1:20)

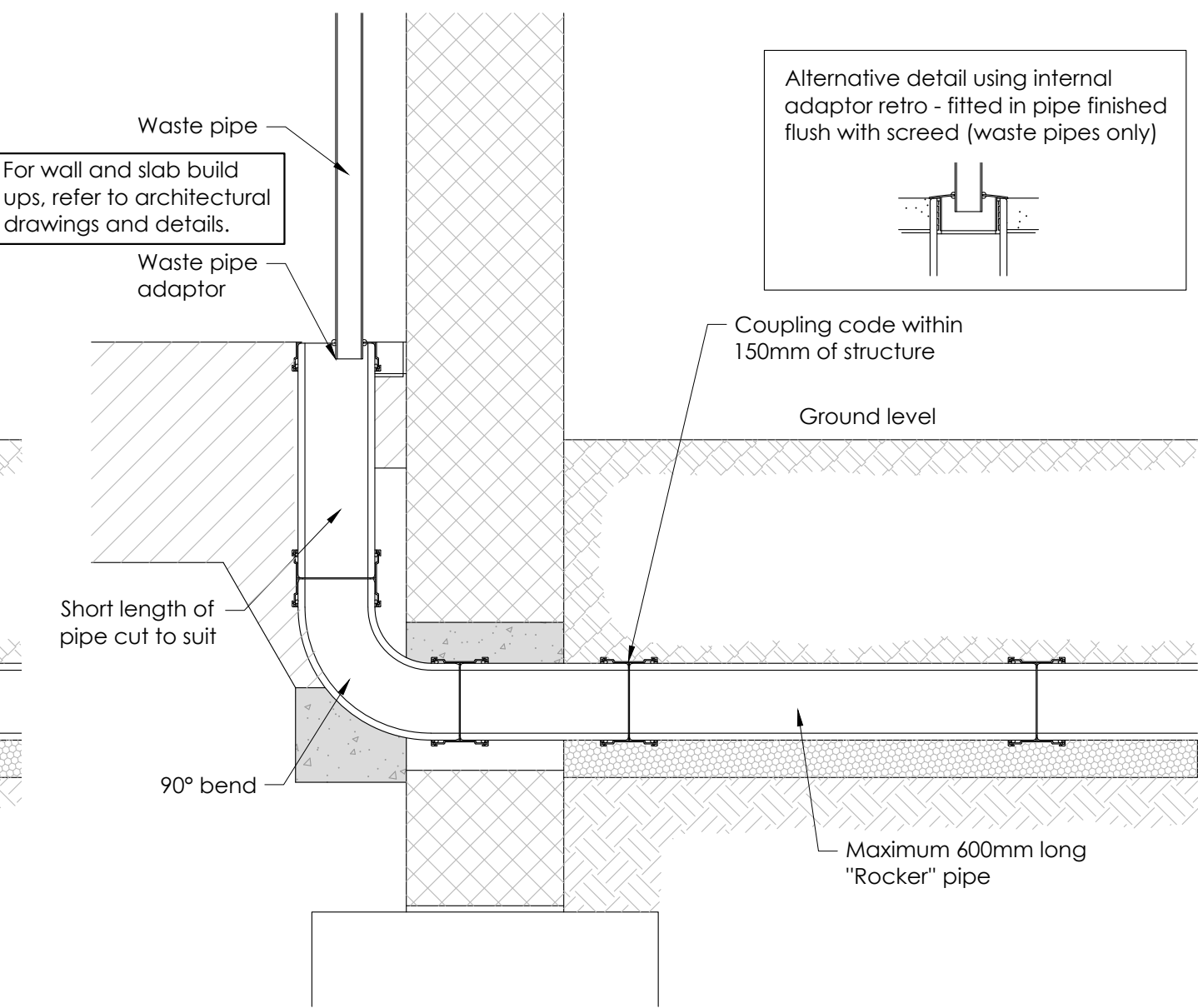

Internal Waste Pipe Connection Detail

(Scale 1:10)

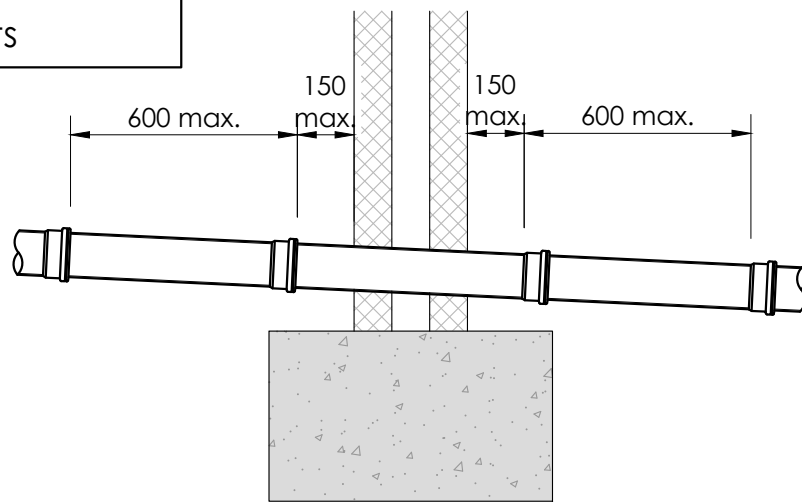

A) Short length of pipe bedded in wall, joints formed within 150mm of either wallface. Adjacent rocker pipes of max. length 600mm with flexible joints.

Do not scale directly from this drawing. All discrepancies are to be brought to the attention of the below office.

The copyright to this drawing is owned by studio 11 architecture.

The General Contractor is to check all dimensions on site and report discrepancies to the designer.

The details and information shown hereon relating to existing underground drains, main services, cables, etc. and existing structural details, are as obtained by normal survey observation method. Although all reasonable effort has been made, no guarantee can be made or given for the completeness or accuracy of this information.

Note:

1. All drawings to be read in conjunction with Structural Engineers Drawings.
2. All dimensions are in millimeters unless noted otherwise.
3. All discrepancies, of any nature to be reported back to the office stated in the title block.
4. If in doubt, ask!
5. Drainage to be constructed in accordance with building regulations part H.
6. Details to be read in conjunction with all other relevant drawings.
7. Setting out to be in accordance with the Architectural plans.
8. All proprietary items to be installed in strict accordance with the manufacturers instructions and recommendations.
9. All works to be carried out in accordance with the current British Standards, Codes for practice and Building Regulations.

REVISION DATE DRAWN DESCRIPTION



KING'S LYNN INNOVATION CENTRE,  
INNOVATION DRIVE, KING'S LYNN,  
PE30 3BY

T: 01553 970033  
E: design@studio11architecture.co.uk  
W: www.studio11architecture.co.uk

CLIENT RTW Construction & Developments LTD

PROJECT Proposed Commercial development at Marsh Lane, Boston

DRAWING Private Drainage Details Sheet 2 of 3

DRAWN	PROJECT DESIGNER	PROJECT DIRECTOR
BJ	KB	KB
DATE	SCALE	PAPER SIZE
01.03.2022	As Shown	A1

DRAWING NUMBER 505-S11-00-SI-DR-C-3201

Working in partnership with Ralph Charman Associates & Beven Consultants