

# TREE PROTECTION MEASURES:

---

SYCAMORE FARM, SYKEMOUTH DROVE, KIRTON, BOSTON PE20 1TS

To accompany an application for holiday let accommodation B/21/0460

---

Our reference: 501\_TS

Report produced: 19 January 2022

REPORT ISSUED IN ELECTRONIC FORMAT ONLY

### Application

The proposal B/21/0460 seeks to install 2 modest cabins nearby to existing trees on site.

### Consideration of Foundations

The principle concept of the cabins is to pose minimal intervention in the landscape and so a low impact foundation is sought. To cause least disruption to the site, within protection zones a screw pile foundation system will be utilised rather than raft or trench footings. Screw piles are twisted into the ground rather than driven or drilled and are considered for use within close proximity to trees.

A screw pile solution will mitigate and minimise any disruption to the existing root base of the trees on site as it is worked into the soil, around the root. Aeration to the soil during the installation process of the piles may actually benefit the trees where the piles are located within the root area,

### During Construction Works

In order to protect the trees on site during construction works, tree protection measures are to be installed. The most appropriate protection for this setting and context is considered to be surface fixed Heras fencing.

These will be installed around the perimeter of the construction area to prevent damage to the trees while site works are carried out. An illustration of the Heras fencing installation is indicated below. Drawing 501\_TP shows the location and extent of the fence line.

### Tree Protection Provisions

Specifications:

Tree Protection Fencing Panels shall be 2.3m high x 3m in length. (see image below).



Image showing example of Heras tree protection fencing in situ

Given the existing soft surface onto which the fencing will be placed in addition to the small, constrained nature of the site, it is considered that Heras fencing will be most appropriate from of tree protection. The Heras fencing will comprise of continuously joined panels, and will be secured utilising an 'above ground stabilizing system', with the fencing base stabilizer strut secured with ground pins with a base plate, as illustrated below:

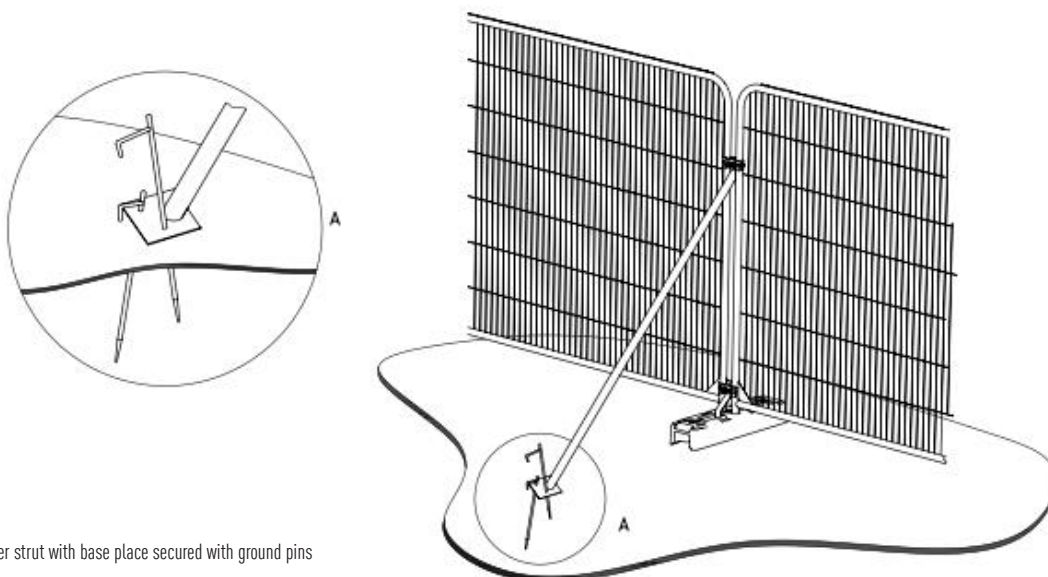

a) Stabilizer strut with base place secured with ground pins

Information contained within this drawing is the sole copyright of Ashman Architects and is not to be reproduced without express permission. No implied licence exists. This drawing not to be used for land transfer or valuation purposes. All dimensions & levels are to be checked on site by the contractor. Issued for purposes indicated only. Drawing errors and omissions to be reported to the architect.

Key Plan

Notes

P1 19/01/2022 Amended siting of Cabin 01 - Planning Issue

Revisions

**ASHMAN Architects**

Tel +44 (0) 208 150 0030  
studio@ashmanarchitects.com  
www.ashmanarchitects.com

Client

Hall

Project

Sycamore House

Project No.

501

Drawing Title

Tree Protection Plan

Status

Planning Application

Drawn

RA

Checked

Scale

1:100 @A3

Date

19/01/2022

Drawing Number

501\_TP

Revision

1

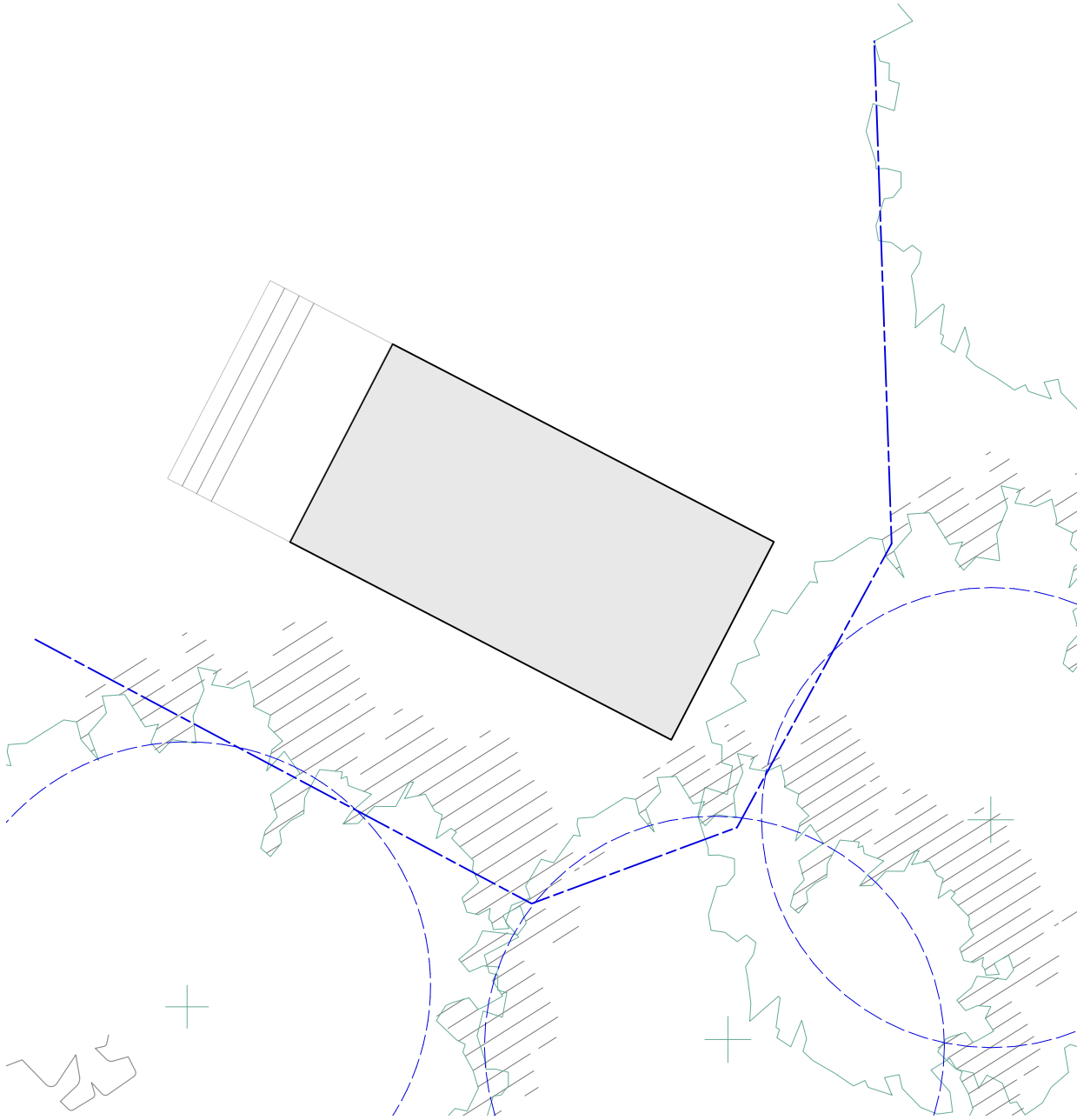

01 - Cabin 01 Tree Protection

1:100 @A3

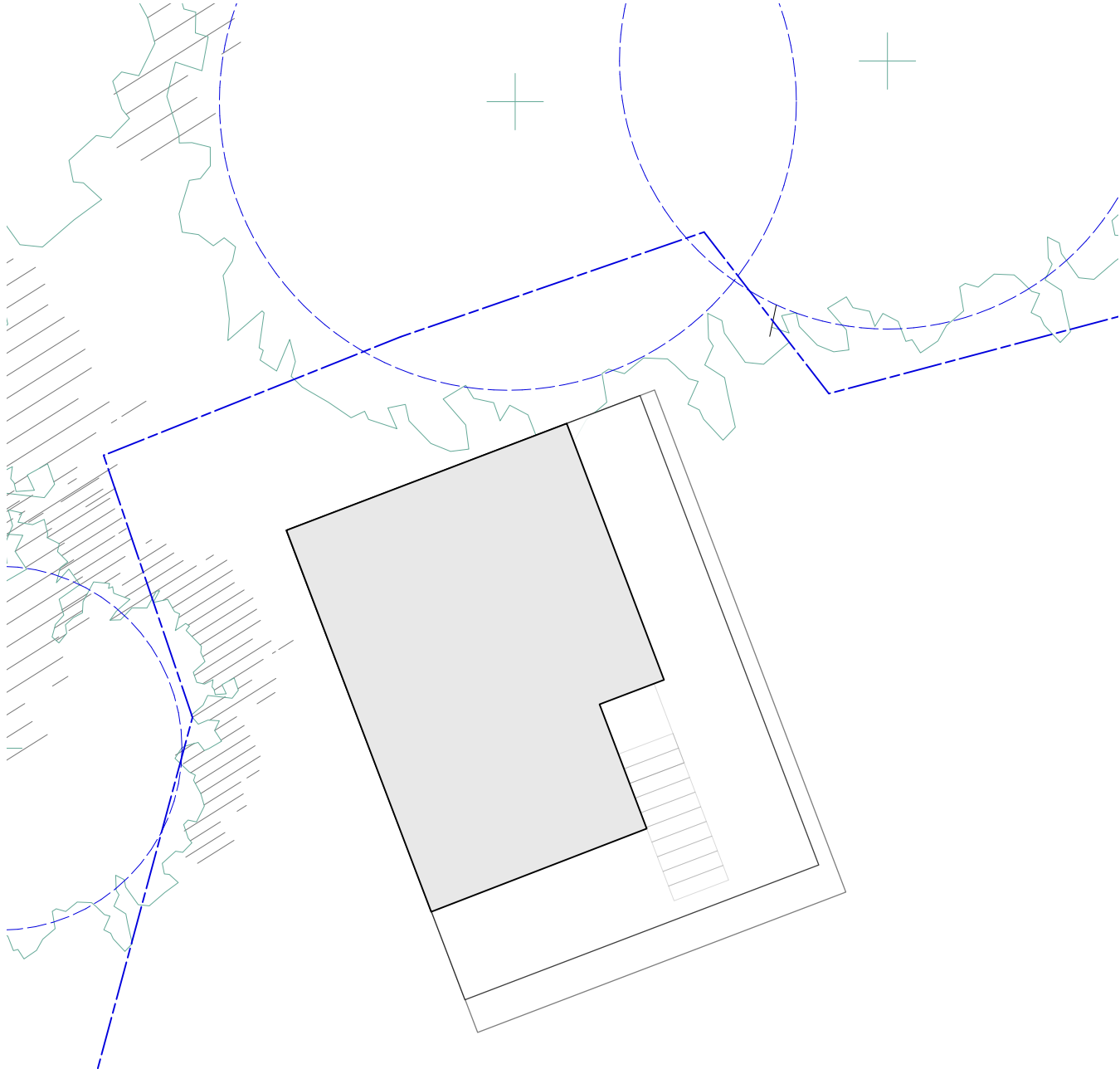

02 - Cabin 02 Tree Protection

1:100 @A3

20m

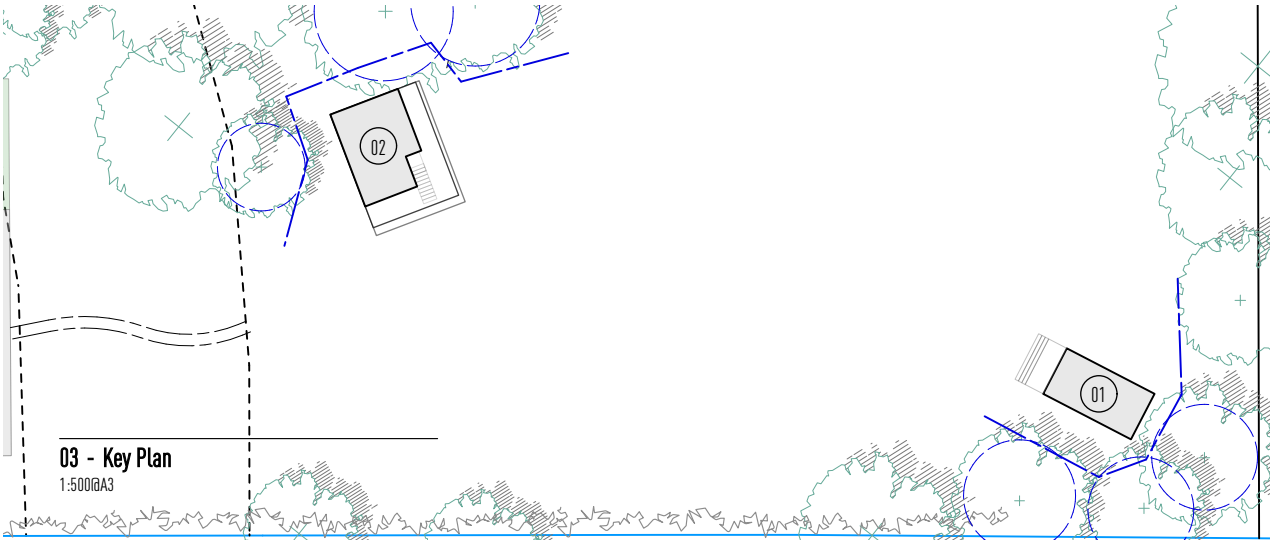

03 - Key Plan

1:500 @A3