

PROPOSED

Proposed Ground Floor Plans

SCALE 1:50

NOTES: All measurements are in mm unless otherwise specified. Do not scale from this drawing. Contractor to check dimensions on site and inform AF Architecture of discrepancies if required. This drawing is subject to Copyright.

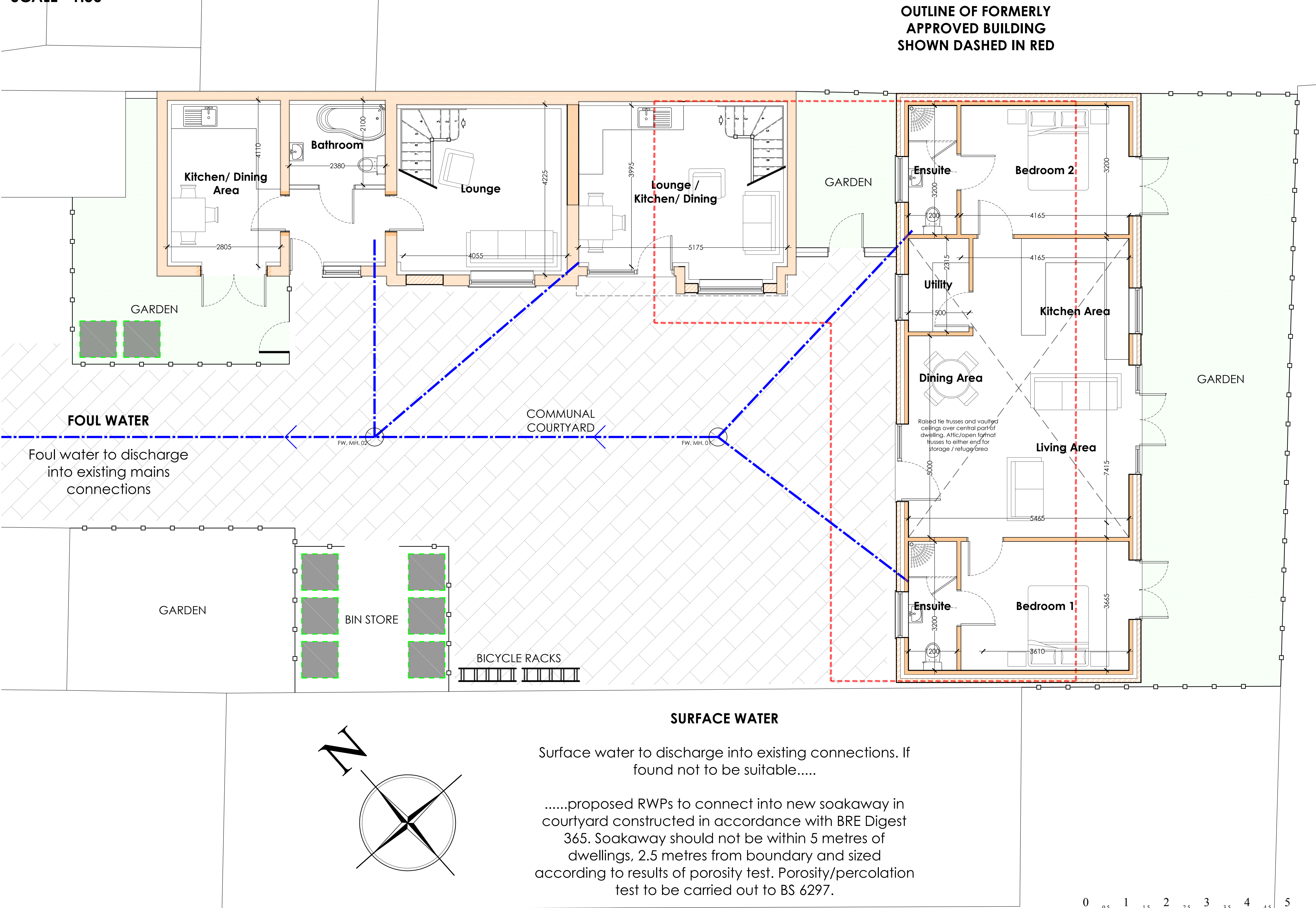

REV. A Scale bar added as requested by B.B.C. 10.11.20 AF  
REV. B Proposal reduced to 1no. new single storey dwelling 18.02.21 AF  
REV. C Former openings blocked up and changed to render finish as discussed with B.B.C. 09.03.21 AF

P R O J E C T I N F O R M A T I O N	<b>AF Architecture</b> 65 Robin Hoods Walk, Boston, Lincolnshire PE21 9EX Tel: 07985635436 E-mail: adrian@afarchitecture.co.uk		
	APPLICANT NAME: Mr. L. Barton		DATE: June 2020
	PROPOSAL: PROPOSED CONVERSION OF EXISTING OUTBUILDINGS TO 2No. DWELLINGS AND CONSTRUCTION OF 1No. NEW DWELLING		
	SITE ADDRESS: Land to rear of 24-26 High Street, Kirton, Boston, Lincolnshire PE20 1EG		
	DRAWING TITLE: Proposed Ground Floor Plans		
DRAWING NO: 20/044/Pr - 01		SCALE: As shown	REVISION: C
			A1

PLANNING DRAWINGS